

# Windows 10 Device Onboarding

Note:

This process is for personal devices only. Windows 10 devices owned and managed by FISD will not work with this process.

For FISD guests, use the guest username and password for your campus. The campus secretaries should have the information.

1. Click the network icon in the bottom right system tray.
2. This screen will popup. Select FISD-Onboarding.
3. You will be directed to this page. Select Start.

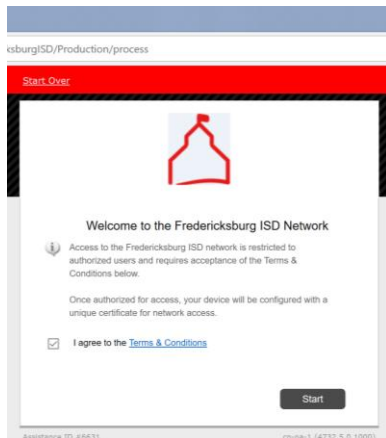

4. Enter your computer username and password here.

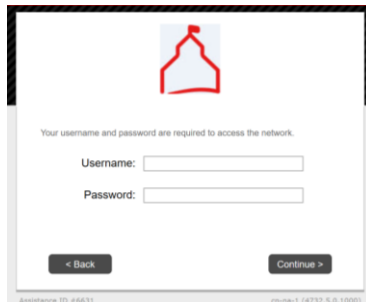

5. Select Download .exe for Windows

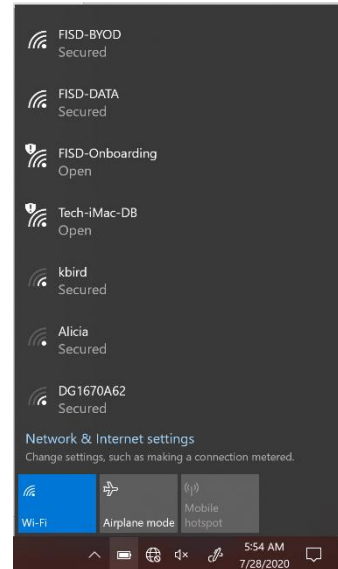
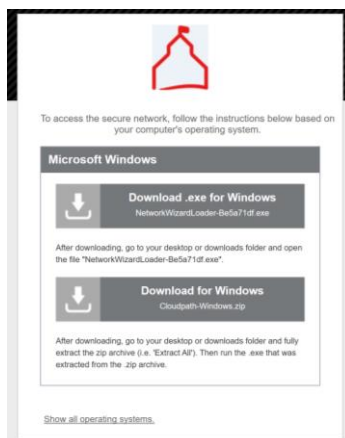

6. Select Run for the application
7. If you get a blue SmartScreen warning, select the Run button.
8. Then select Yes.
9. Allow the program to load the configuration.



10. Select Yes for the certificate installation.

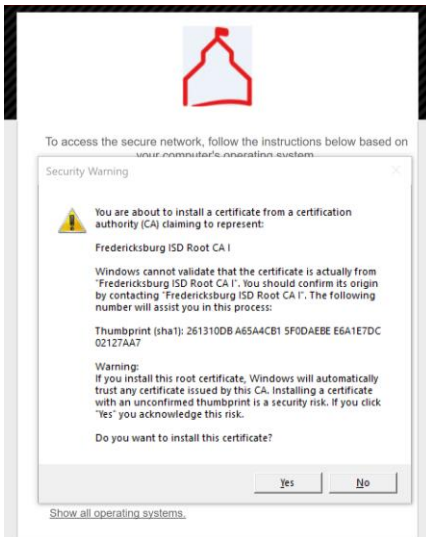

11. If all goes well, you will see this screen.

